

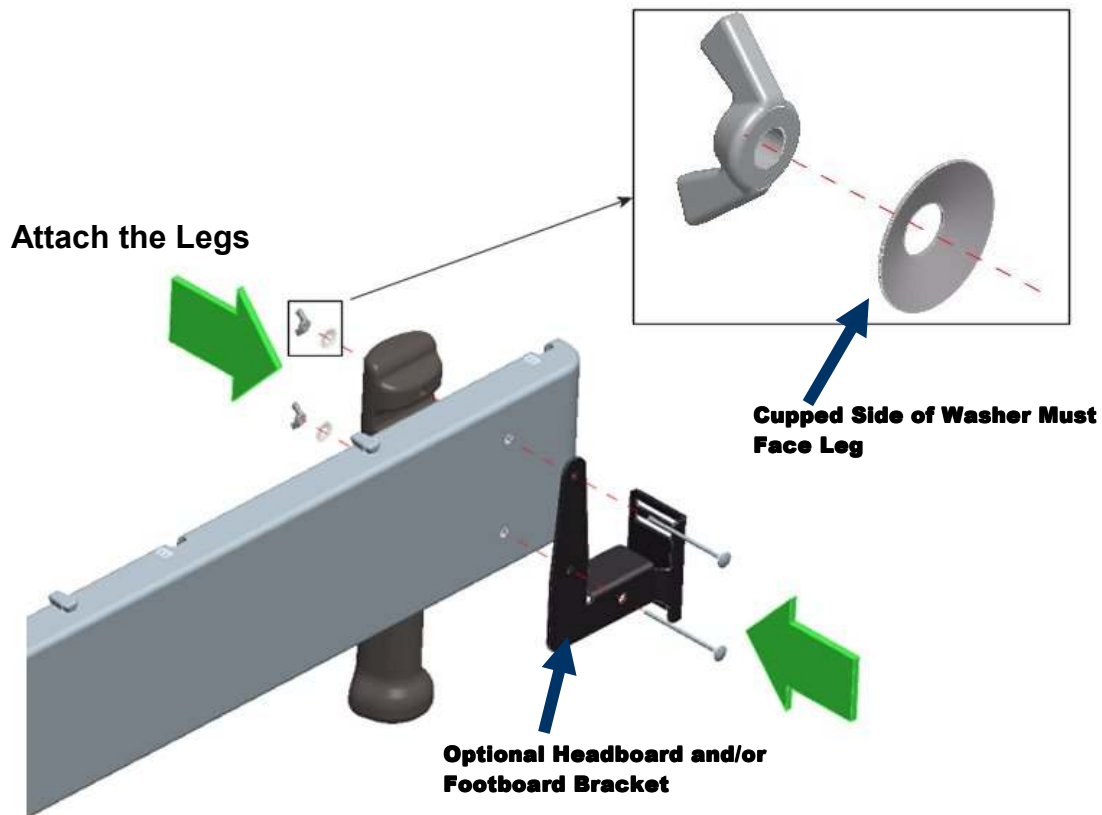

Modular Base Legs Assembly Instructions

The Modular Base (Foundation) Legs should be installed after **Step 2** of the Modular Base (Foundation) Assembly section in the SLEEP NUMBER® bed assembly guide.



1. Insert bolt through optional headboard bracket (if applicable), side rail, and leg holes. Hand-tighten wing nut and spring washer. **Cupped side of the washer must face towards the leg.** Repeat for other hole and tighten firmly.
2. Repeat for remaining two legs on same side (middle and end), and three remaining legs on other side of bed.
3. Make sure spring washer and wing nut are tight and head of carriage bolt is flush with side rail.
4. If you have a King size bed, repeat the steps above for your second foundation.
5. Continue with the remaining modular base (foundation) assembly steps in the assembly guide.
6. Check wing nut 2-3 days after initial assembly to ensure proper tightness.